



VAG-  
Armaturen  
GmbH

**VAG**

**VAG SKR**

**Slanted seat tilting disk check Valve**

**Better damping than slamming**



# VAG SKR

## Slanted seat tilting disk check Valve

Short closing time – pressure surge safe – wear resistant

A fast reversal of flow direction in conventional swing check valves is often followed by loud slams and mechanical pressure surges stressing pipelines and foundations.

In the event of the back flow suddenly stopping, pressure surges can lead to the destruction of the pipeline.

VAG SKR Slanted seat tilting disk check Valve is an answer to these problems by its innovative design and its adaptability to the respective installation conditions.

### Product characteristics

- travel of disk reduced by 25 % due to slanted position of the seat, closing time also reduced
- Disk closes without slamming due to damping unit activated at 10 to 15 % before final closing position of the disk. (optional)
- compact design
- metallic sealing, corrosion and wear resistant sealing surfaces
- face-to-face dimension according to EN 558-1, basic series 14 (production range F4, DIN 3202)

### Damping movement

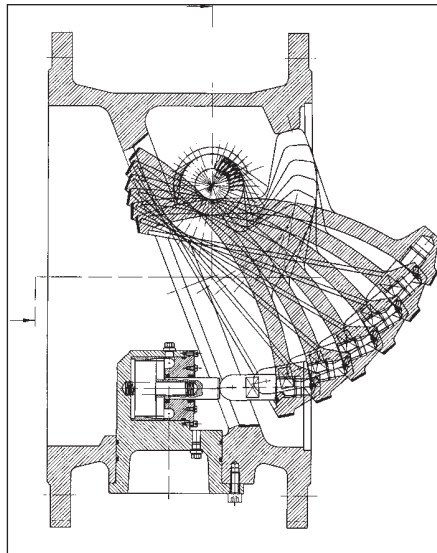

### Closing characteristic

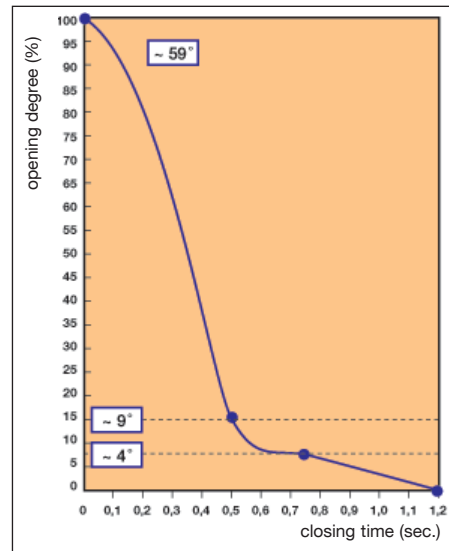

### Customer's advantages

- little space required
- flow controlled free swinging into open and close position
- no external shafts, therefore no friction of respective sealing parts
- no levers or weights, therefore no dangerous striking movements in the operational area
- Damping characteristic is harmonised with dynamic behaviour of the valve disk. Thrusts will be absorbed where occurring, therefore no mechanical transmission to outside equipment required.
- soft contact between valve disk and damping unit, therefore shock-free closing of the disk
- damper unit completely retro-fittable without dismantling the valve from the pipeline, damper unit dismantlable for maintenance

# VAG SKR

## Slanted seat tilting disk check Valve

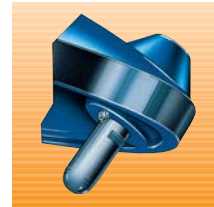
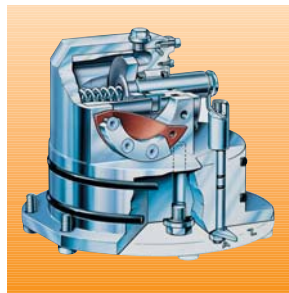

### Design and purpose

- Nominal size DN 200...1000
- pressure ranges PN 10 and PN 16
- maximum admissible operational temperature for neutral liquids: 50°C (122°F)

#### The following on request

- with internal damper
- with cover (prepared for internal damper)
- with position indicator (either mechanic or electric)
- internally rubber-lined
- pressure range PN 25

### Material and corrosion protection

- body and disk made of ductile cast iron EN-JS 1030 (GGG-40)  
**different body materials on request**
- disk shaft made of stainless steel 1.4021
- shaft bearing made of zinc-free bronze
- sealing surfaces made of Ni, welded-on, micro-finished
- inside and outside double epoxy coating, blue colour, RAL 5005

# VAG SKR

## Slanted seat tilting disk check Valve

The right design for your installation



With position indicated  
(either mechanic orelectric)



Design NIRO-forged  
(1.4571)



Design Steel welded  
PN 25



Design with open-end  
damper



**VAG-  
Armaturen  
GmbH**

Carl-Reuther-Str. 1  
68305 Mannheim  
Germany  
Phone +49 621 749-0  
Fax +49 621 749-2153  
info@vag-armaturen.com  
www.vag-armaturen.com

**VAG**